

REVISIONS					
REV	ECO	DESCRIPTION	DATE	BY	APPR
B1	-	RELEASE NEW DWG FORMAT	06/16/14	TOD	TOMMY
B2	-	UPDTAED SPECIFICATION	09/14/15	TOD	TOMMY

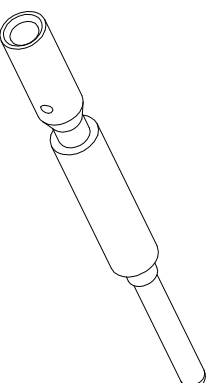
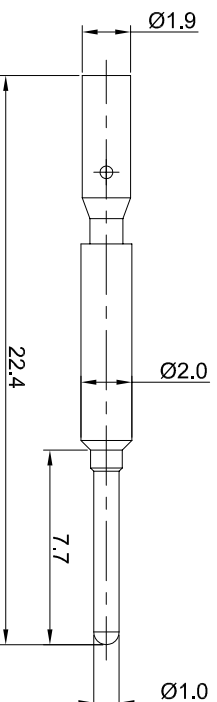
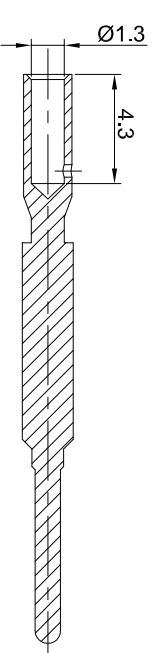

NOTES: UNLESS OTHERWISE SPECIFIED

1. MATERIAL: COPPER ALLOY, GOLD PLATED

2. SPECIFICATIONS:

2.1 RATED CURRENT: 10 AMPS

2.2 CONTACT RESISTANCE: <5 milliohm

2.3 AVAILABLE WIRE RANGE: 22AWG~18AWG

2.4 ROHS COMPLIANT

3. ALL DIMENSIONS ARE FOR REFERENCE USE ONLY.

TITLE: Pin Contact, 20#, Chimp 22-18AWG
 DWG NO: SC000035
 REV: B2
 SH: 1
 OF: 1

QUANTITY	SEE PART NUMBER CHART	PART NUMBER	DESCRIPTION	ITEM
----------	-----------------------	-------------	-------------	------

MATERIALS LIST

UNLESS OTHERWISE SPECIFIED 1) All dimensions are in millimeters. 2) Tolerances are as follows: 1 Pl. DEC 20.030 Fractions 1/164 2 Pl. DEC 20.030 Fractions 1/164 3 Pl. DEC 20.030 Fractions 1/164 3) Note reference = MATERIAL SPECIFICATIONS:	SIGNATURES	DATE	CUSTOMER:
DRAWN: CHECKED: ENGINEER: APPROVAL:	 	09/14/15	Sine Systems - www.amphenol-sine.com 44724 Modely Drive Clifton Township, MI 48036

PROCESS SPECIFICATIONS: NEXT ASSY:	THIS DRAWING IS SUPPLIED FOR INFORMATION ONLY. DESIGN FEATURES, SPECIFICATIONS AND PERFORMANCE DATA ARE SUBJECT TO CHANGE WITHOUT NOTICE. THE APPLICABLE CORPORATION HOLDS ALL RIGHTS IN THIS DRAWING. ALL RIGHTS RESERVED. MANUFACTURING VARIATIONS:	SIZE: B TYPE: C- SCALE: NONE	DWG NO: SC000035 SHEET 1 OF 1	REVISION: B2
---------------------------------------	---	------------------------------------	----------------------------------	--------------