

**RIGHT ANGLE MALE MMS - 200 MM**

**R285.001.021**

**2/50 S-BR CABLE**

Series : **CORD-SPECIF**

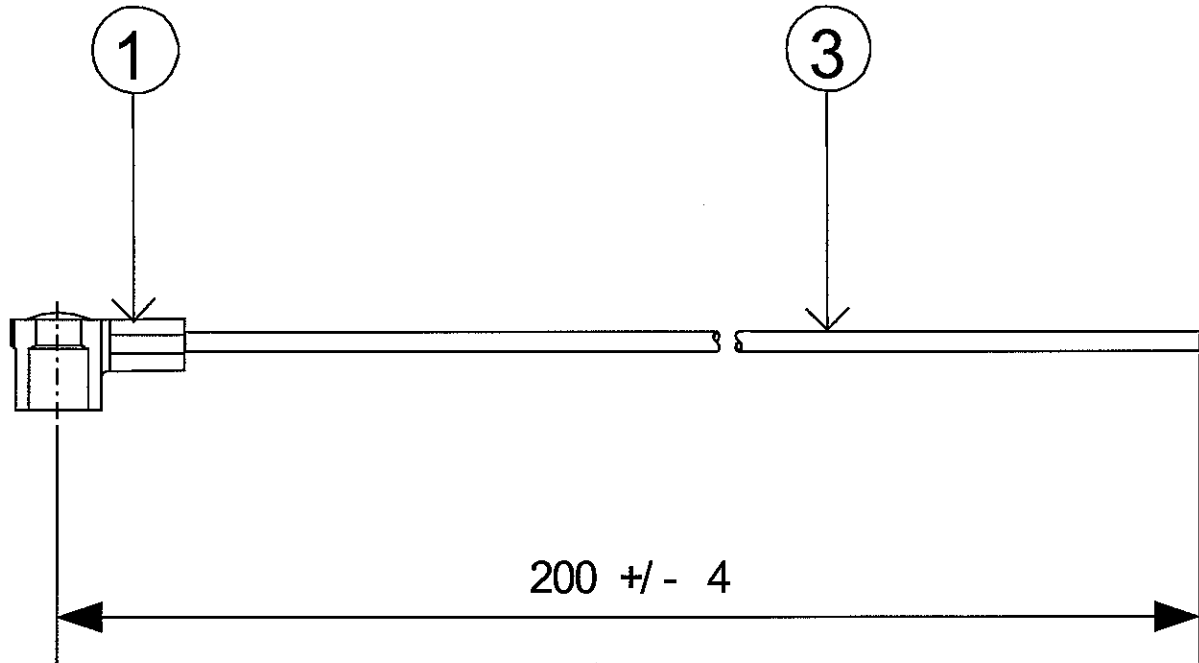

All dimensions are in mm.

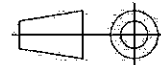

- \* 1 \* Connector A : **R209.353.000**
  - \* 2 \* Connector B : **-**
  - \* 3 \* Cable : **C291.145.007**
- Type : **CAB HF 2/50 RG 178 BROWN**

**ELECTRICAL CHARACTERISTICS**

**SPECIFICATION**

|                                 |             |                            |
|---------------------------------|-------------|----------------------------|
| Impedance                       |             | <b>50 Ω</b>                |
| Frequency                       |             | <b>0-6 GHz</b>             |
| Operating temperature           |             | <b>-40/+90 ° C</b>         |
| VSWR                            | <b>NA +</b> | <b>0.000 x F(GHz) Maxi</b> |
| Insertion loss                  |             | <b>NA √F(GHz) dB Maxi</b>  |
| Voltage rating                  |             | <b>50 Veff Maxi</b>        |
| Dielectric withstanding voltage |             | <b>250 Veff mini</b>       |
| Insulation resistance           |             | <b>500 MΩ mini</b>         |

|          |                  |
|----------|------------------|
| Weight   | <b>1.900 g</b>   |
| Cable    | <b>20 N mini</b> |
| Others : | <b>-</b>         |

